

QD2, 4, 8, & 14 SWIVEL ASSEMBLY

REVISIONS				
ZONE	REV.	DESCRIPTION	DATE	APPROVED

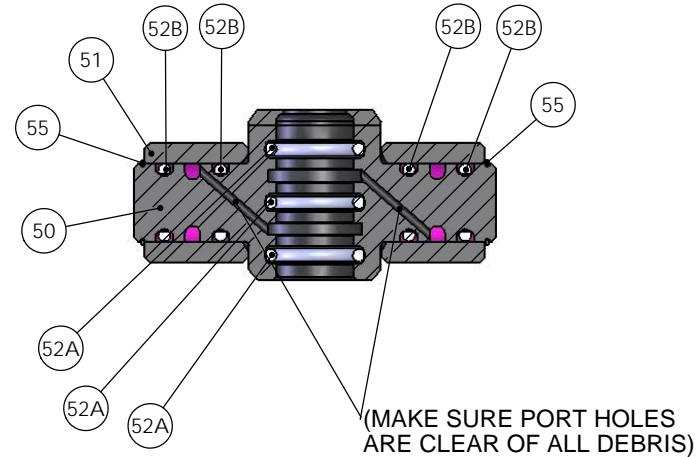
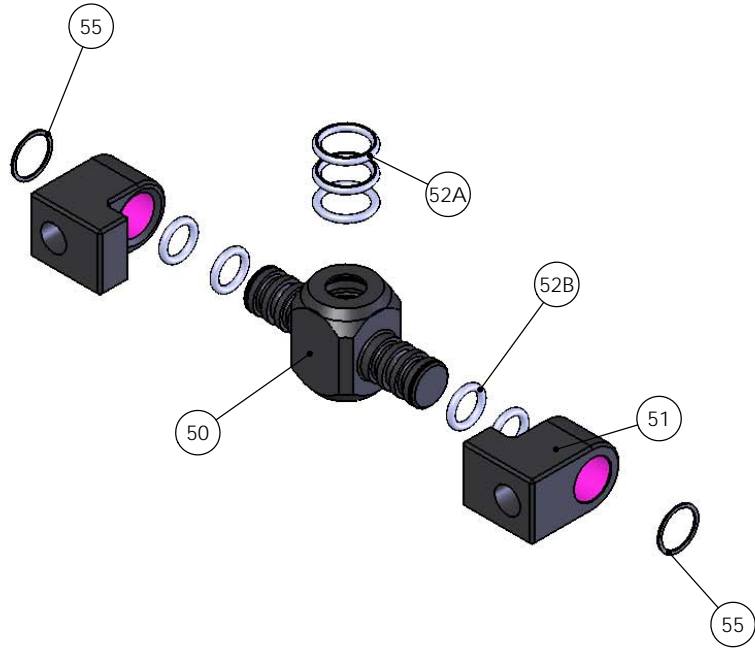

ASSEMBLY INSTRUCTIONS

1. INSERT SWIVEL POST O-RINGS (ITEM 52A) INTO SWIVEL BODY (ITEM 50) AS SHOWN IN SECTION A-A.
2. SLIDE SWIVEL ARM O-RINGS (ITEM 52B) OVER SWIVEL BODY AS SHOWN IN SECTION A-A
3. SLIDE SWIVELS (ITEM 51) OVER SWIVEL BODY AND SECURE WITH SWIVEL SNAP RINGS (ITEM 55) AS SHOWN IN SECTION A-A.

NOTE: USING A PIECE OF WIRE, MAKE SURE PORT HOLES ARE CLEAR OF DEBRIS.

ALL O-RINGS COME IN THE SWIVEL SEAL KIT

= USE LUBRICATION IN THIS AREA

SOFTWARE: SOLID WORKS	DATE	NAME	BOLTTECH <small>We Own the Future of Bolting Technology</small>	
UNLESS OTHERWISE SPECIFIED: DIMENSIONS ARE IN INCHES FRACTIONAL +/- 1/32" ANGULAR +/- 1/2 DEGREE TWO PLACE DECIMAL +/- 0.01 THREE PLACE DECIMAL +/- 0.005	DRAWN		CUSTOMER:	
	CHECKED		TITLE:	
	ENG APPR.		SIZE DWG. NO. REV	
	MFG APPR.		SCALE: 1:2 WEIGHT: SHEET 8 OF 18	
MATERIAL			PROPRIETARY AND CONFIDENTIAL THE INFORMATION CONTAINED IN THIS DRAWING IS THE SOLE PROPERTY OF BOLTTECH. ANY REPRODUCTION IN PART OR AS A WHOLE WITHOUT THE WRITTEN PERMISSION OF BOLTTECH IS PROHIBITED.	
HEAT TREAT				
FINISH				